

cortina

Guardaroba aperto per cabine armadio, attrezzato con tutti gli elementi per personalizzare e ottimizzare capienza e funzionalità degli spazi. Particolare attenzione è stata dedicata agli elementi verticali che non sono considerati come dei semplici schienali, ma danno vita alle pareti, diventano protagonisti grazie alla finitura a motivi rigati in rilievo.

In particolare, per mantenere l'effetto scenico delle pannellature a rilievo, si è optato per ante di ampie dimensioni, e quindi con sistemi di apertura scorrevole o complanar.

Struttura in legno multistrato.

Piani e contenitori finiti in essenza.

Rivestimento frontali cassetti in pelle P2.

Pannelli schienale a giorno e ante in legno multistrato rivestite in pelle sintetica con lavorazione a rilievo tridimensionale.

Accessori in metallo verniciato.

Aste appendieria in metallo verniciato con particolari rivestiti in pelle.

Kit accessori in pelle P2 per cassettiere (opzionale).

Illuminazione a LED (opzionale).

An open wardrobe for walk-in closets, equipped with all the elements to customize and optimize the capacity and functionality of spaces. Special attention has been paid to vertical elements that are not just considered as simple backrests, but which make the walls come alive and become the protagonists thanks to the finishing of striped motifs in relief.

In particular, to maintain the scenic in-relief effect of the panels, we opted for large doors, with sliding or coplanar opening systems.

Structure in plywood.

Tops and storage units finished with wood essence.

Covering of the front of the drawers in leather P2.

Open back panels and doors in plywood covered in synthetic leather with three-dimensional relief.

Accessories in painted metal.

Hanging rails in painted metal with details covered in leather P2.

Accessory kit for drawers covered in leather (optional).

LED lighting (optional).

open modules

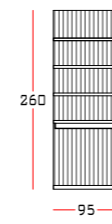

A



B



C



D



E

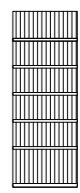

F



G



H

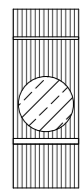

I



L



doors

compositions

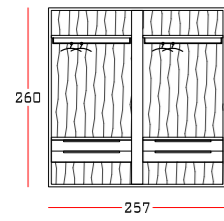
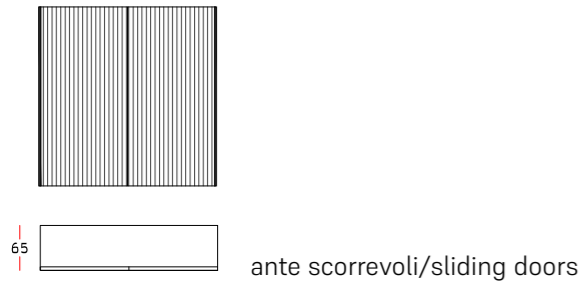

J

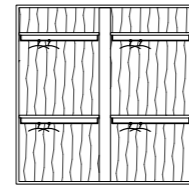

K

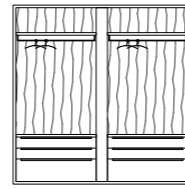

W

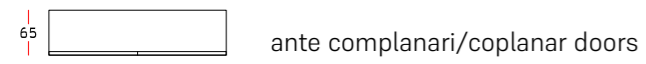
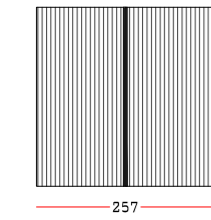

J

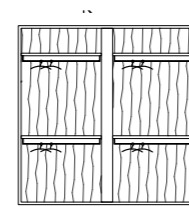

K

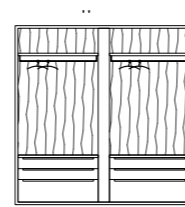

W

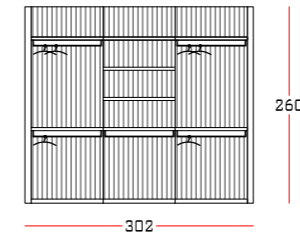

B+A+B

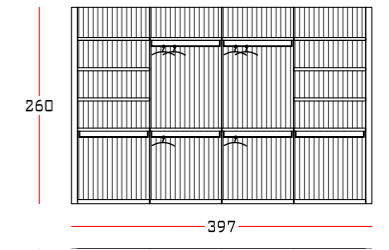

A+B+B+A

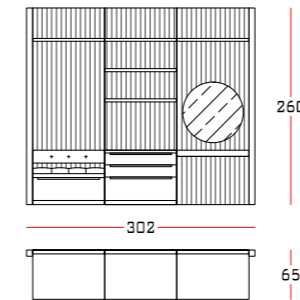

H+C+I

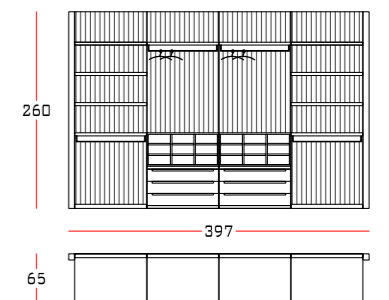

A+G+G+A

leather CAT. P2 NUVOLA

front drawers/hanging rails details/accessory kit



117 Neve 198 Ostrica 199 Canapa 179 Lino 159 Creta 174 Siena 208 Zabaione 131 Cuoio

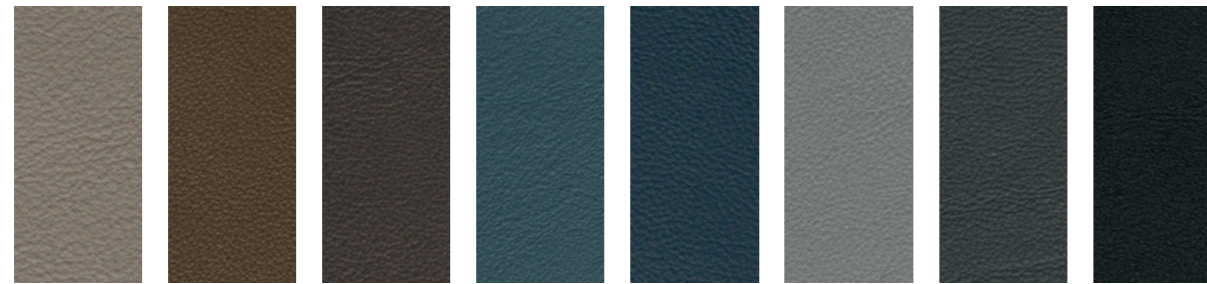

207 Camoscio 217 Fango 147 Moretto 164 Ottanio 154 Zaffiro 203 Elefante 141 Antracite 101 Nero

synthetic leather CAT. B INCA

open back panels and doors

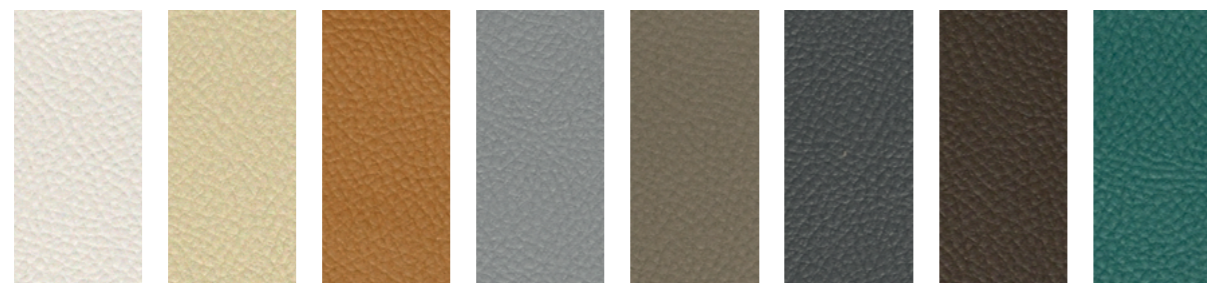

10000 9310 13646 9327 13257 12515 13258 9277

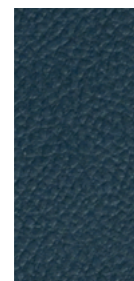

9332

woods

structure/top and storage



Noce Italiano Biondo Teak Gold Noce Canaletto Rovere thermo

metals

accessories/hanging rails



Argento Bronzo Blu Ossido Piombo

Dimensions in centrimetres. The company has the right to modify the models without prior notice. The information given here are based on the latest product information available at the time of printing.

Shades of colours shown as samples may vary due to the fact that they appear on paper, it is for this reason that all colours are considered indicative and the company will not be liable for differences should they arise in the final product.